

**LOT 1 in BLOCK 10 in SCHLEKEWY ADDITION
IN GOVT LOT 3 OF SECTION 13,
T126N, R54W OF THE 5TH P.M.,
MARSHALL COUNTY, SOUTH DAKOTA**

I, LUNDEE M. STAYTLER, A REGISTERED LAND SURVEYOR IN THE STATE OF SOUTH DAKOTA, DO HEREBY CERTIFY THAT I HAVE SUPERVISED THE RESURVEY OF THE PROPERTY THAT IS DESCRIBED ABOVE, AND THAT SAID SURVEY AND DRAWING ARE TRUE AND CORRECT.

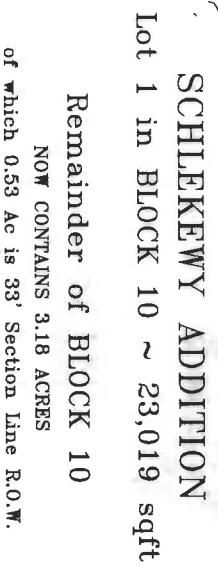

BAIR'S
SECOND
ADDITION

Lot 1

SCHLEKEWY DRIVE WEST

442ND AVE

**UNPLATTED PORTION
GOVT LOT 3**

Previously Dedicated to Road Purposes

LOT 1

SCHLEKEWY ADDITION

CLEAR LAKE

EAST VIEW
ADDITION.

BLOCK 5

BLOCK 10
SCHLEKEWY ADDITION
S25°56'18"W

BLOCK

SCHLEKEYWY ADDITION

Lot 1 in BLOCK 10 ~ 23,019 sqft

Remainder of BLOCK 10

NOW CONTAINS 3.18 ACRES

of which 0.53 Ac is 33' Section Line R.O.W.



Holton
SURVEYING & DESIGN, LLC

128 E HICKORY ST, SISSETON SD	PH 605-698-3850
DRAWN: 7/29/25	FIELD: 7/2025
1312854-P0599	
PLAT\MARSHALL\METWP\SECTION2\BLOCK10\REPLAT.DWG	



GPS-NORTH
SCALE: 1" = 125'
O = CAPED IRON PIN SET
X = RECOVERED MONUMENT

SURVEY PERFORMED WITHOUT THE BENEFIT OF A TITLE COMMITMENT

LUNDEE M STADTLER
REGISTERED LAND SURVEYOR 13482